

DOCUMENT DETAILS <div>V1</div>	
Product:	Car Play Adapter
Type:	User Manual
Date Updated:	6-11-2025

# Amkette Drive Cast

## Car Play Adapter QSG

### Front

#### WARRANTY STATEMENT

Amkette Drive Cast 2-in-1 Wireless CarPlay Adapter is backed by a 1 Year performance warranty against any manufacturing defects in material or workmanship from the date of original purchase. This warranty entitles the purchaser to get the product repaired or replaced at its discretion under the following conditions:

- The warranty applies to the original purchaser. Proof of original purchase is required.
- The warranty does not cover the damage caused by misuse, abuse or improper storage.
- In no event shall Amkette be responsible for any direct, incidental, consequential or other damages of any kind.

Please contact our Customer Support Line and/or send the defective product, together with the proof of purchase to our Customer Care Service Center to avail warranty service. Return charges will be paid by us.

#### CUSTOMER CARE SERVICE CENTRE

Amkette House, C-64 / 4, Okhla Phase – II, New Delhi – 110020

1800-11-9090 (Toll Free) (9:30 AM - 6:00 PM) Mon – Sat +91 9312691448 (9:30 AM - 6:00 PM) Mon – Sat

techsupport@amkette.in

For Hassle Free Service Register your product online at [www.amkette.com/register](http://www.amkette.com/register)



**IMPORTANT**  
Please read this manual carefully before first use to ensure correct installation, safe operation, and the best performance of your Amkette Drive Cast 2-in-1 Wireless CarPlay Adapter.

Quick Start Guide

### Back

#### PRODUCT OVERVIEW

Amkette Drive Cast 2-in-1 Wireless CarPlay Adapter is a compact Wi-Fi & adapter that converts your car's wired CarPlay or Android Auto into a seamless wireless experience. It connects instantly, retains full OEM controls, and keeps your dashboard wire-free.

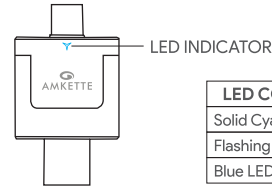

LED COLOR	STATUS
Solid Cyan	Powered On
Flashing Blue	Connecting to Phone
Blue LED Stables	Connected Successfully

#### COMPATIBILITY

- Works with cars that have factory-installed wired CarPlay or Android Auto.
- Supports iPhone (iOS 12.1 or above) and Android (Android 10.0 or above).
- Plug & Play with both USB-A and Type-C ports.

#### 15) LED OFF or flickers; adapter restarts randomly

This indicates unstable 5 V power or a charge-only port. Move to the OEM data port, avoid hubs/extenders, and test on a simple 5 V USB charger to confirm stability before reconnecting to the car.

#### SPECIFICATIONS

Chipset	AX1800
Wi-Fi Version	Wi-Fi 6
Bluetooth	5.4
Frequency	2402 – 2480 MHz
Connectivity	USB-A + USB-C (2-in-1)
Input Voltage	5 V
Firmware	Upgradable (Online)
Supported Systems	OEM installed Wired Apple CarPlay or Android Auto
Dimensions	47 × 27 × 10.5 mm
Weight	12 g

#### 12) Can't reach pairing/connection screens at all

Some cars have multiple USB behaviors; try each OEM smartphone-integration port and avoid extenders. Start car → Insert DriveCast → follow 3-step flow (Plug → Wi-Fi/BT ON → Pair "Amkette DriveCast").

#### 13) Steering-wheel buttons or rotary knob don't control apps

Some head units map controls only after CarPlay/Android Auto fully initializes. Quit and relaunch CarPlay/Android Auto once connected, ensure no other BT audio profile is active, and check the hardware unit's control settings are enabled for smartphone projection.

#### 14) Switching between iPhone and Android is inconsistent

Each phone stores its own pairing profile. Forget DriveCast on both phones (and in the Hardware Unit if listed), then pair the phone you want to prioritize first. On the non-primary phone, keep Bluetooth OFF until the primary completes auto-launch.

#### CONNECTION- APPLE CARPLAY

##### 1. PAIRING

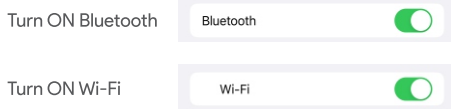

On your iPhone, go to Settings → Bluetooth, and connect to "Amkette DriveCast".

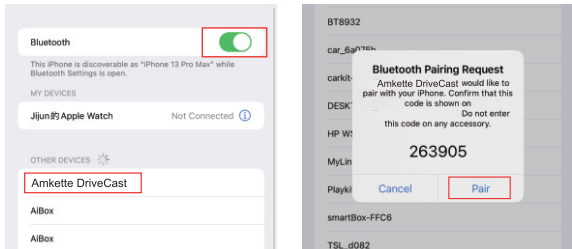

##### 2. CONNECTING

Once paired, the screen will automatically switch to Apple CarPlay (Wireless).



Next time you start your car, DriveCast connects automatically.

#### 8) Head unit restarts or shows "Accessory Not Supported"

Use a direct OEM port (no splitters). Ensure CarPlay/Android Auto is enabled in hardware unit settings and update hardware unit firmware if available.

#### 9) Bluetooth shows connected, but screen stays on home

Delete the pairing on phone and hardware unit, reboot both, then pair again ensuring Wi-Fi remains ON during setup. Avoid connecting to other in-car Bluetooth devices until DriveCast finishes launching.

#### 10) OTA update page doesn't open

Power DriveCast from a simple 5 V USB charger. Connect phone to the adapter's Wi-Fi (see QSG), open 192.168.1101, and turn Mobile Data OFF while updating for a stable session.

#### 11) How do I upload the log data if the adapter doesn't work?

Please enter the IP address page & fill in the car info in the problem description sheet, and press "Submit" to upload your log data.

#### 4) Auto-connect doesn't work next time

On the phone, Forget "Amkette DriveCast" and re-pair. Turn Personal Hotspot/VPN off during reconnection and allow Wi-Fi/BT to run in background (no battery restrictions).

#### 5) Why does the indicator stay on after I switch off the car?

Many vehicles keep the USB/accessory power alive for a short "sleep" period after ignition OFF. During this time, DriveCast's light may remain ON for a few minutes and then shut off automatically. Power draw is very low and will not drain your car's battery.

#### 6) Call issues (low volume / echo / mic not heard)

Raise call volume on the head unit (separate from media). For echo, lower cabin volume a notch and keep the phone away from roof mics; disable voice-altering/noise apps during calls.

#### 7) Navigation voice missing or too loud

Set Guidance Volume in Maps. Enable Mix with media (if available) so prompts overlay music.

#### CONNECTION- ANDROID AUTO

##### 1. PAIRING

Insert the Amkette DriveCast into your car's USB-A or Type-C data port. Wait for the indicator light to turn on and the device screen to appear on your car display.

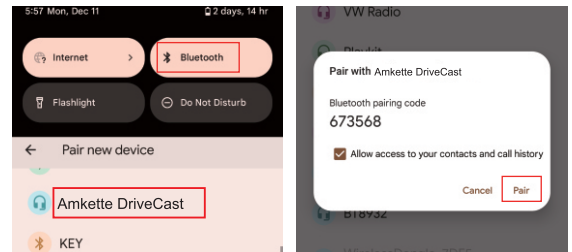

##### Connected devices

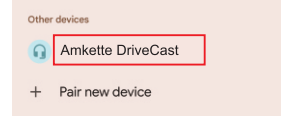

##### 2. CONNECTING

Once connected, your car screen will automatically switch to Android Auto (Wireless).



Next time you start your car, DriveCast connects automatically.

#### FIRMWARE UPGRADE (OTA UPDATE)

- Plug DriveCast into any 5 V power source (avoid car data port).
- Connect your phone to the DriveCast Wi-Fi network (Amkette DriveCast, Password: 12345678).
- Open a browser and enter 192.168.1101.
- Select Online Upgrade and wait a few minutes.
- Forget the Wi-Fi network after update completes.

#### TROUBLESHOOTING AND FAQs

##### 1) Car doesn't detect the adapter

Use the OEM data USB/Type-C port (not charge-only), avoid hubs/extenderns, try the other factory port, then restart the head unit and re-insert DriveCast.

##### 2) "Amkette DriveCast" not visible in Bluetooth

Toggle phone Bluetooth OFF → ON, delete old car/adapter entries from the paired list, keep the phone near the console, then scan again.

##### 3) Paired, but CarPlay/Android Auto doesn't start

Wireless projection needs Wi-Fi + Bluetooth. Turn Wi-Fi ON, re-pair, and allow all prompts.  
iPhone: Settings → General → CarPlay → your car → Allow While Locked.

Android: Android Auto → Connected cars → Add new / enable Wireless AA.