

DOCUMENT DETAILS <div>V1</div>	
Product:	XS Flow
Type:	QSG
Date Updated:	24-07-2025

#### Troubleshooting & Tips

##### Mouse not connecting via Bluetooth?

- Ensure the mouse is in Bluetooth mode (blue indicator).
- Hold the switch button until the light blinks to enter pairing mode.
- Reconnect from your device's Bluetooth settings.

##### Horizontal scroll not working?

- Supported only in applications that allow side scrolling (e.g., Excel, video editing software).

##### Cursor lag or skipping?

- Ensure battery is sufficiently charged.
- Use on a smooth, non-reflective surface.

##### Mouse not responding at all?

- Turn the mouse OFF and ON again.
- Reconnect or try another USB port.
- If using Bluetooth, try forgetting and re-pair the mouse.

##### Show Desktop button not working?

- Make sure your mouse is in correct OS mode.
- Toggle between macOS/Windows by pressing Show Desktop button for 3 seconds.

##### Device switching not working?

- Press the Device switch button once and wait for 2–3 seconds.
- Try re-pairing the mouse.

##### Battery draining faster than expected?

- Disable RGB lighting by long-pressing the DPI button.
- Avoid using the mouse while charging for optimal battery health.
- Ensure the mouse is turned OFF when not in use for long periods.

5

#### POWER SAVING MODE

The XS Series Flow Wireless Mouse utilizes energy-efficient 2.4GHz wireless and Bluetooth technology. With its smart power-saving feature, the mouse enters standby mode after 1 minute of inactivity and switches to deep sleep mode after 10 minutes. Simply click any button to wake it up.

#### SPECIFICATIONS

Connection Type	:	Bluetooth and USB 2.4GHz
Devices	:	4 (3x Bluetooth and 1x USB 2.4GHz)
DPI	:	400-800- <b>1600 (Default)</b> -2400-3200
Buttons	:	8
Battery	:	600mAh
On/Off Switch	:	Yes
Product Weight	:	112g
Product Dimensions	:	123 x 84 x 51mm

#### WARRANTY STATEMENT

Amkette XS Series Flow Wireless Mouse is backed by a 1 Year performance warranty against any manufacturing defect in material or workmanship from the date of original purchase. This warranty entitles the purchaser to get the product repaired or replaced at its discrete under the following conditions:

- The warranty applies to the original purchaser. Proof of original purchase is required.
- The warranty does not cover the damage caused by misuse, abuse or improper storage.
- In no event shall Amkette be responsible for any direct, incidental, consequential or other damages of any kind.

Please contact our Technical Support Line and/or send the defective product, postage pre-paid, together with the proof of purchase to our Customer Care Service Center to avail warranty service. Return postage will be paid by us.

#### CUSTOMER CARE SERVICE CENTER

Amkette House, C-64/4, Okhla, Phase-II, New Delhi-110020

1800-11-0090 (Toll Free)  
(9:30 AM - 6:00 PM) Monday – Saturday

+91 9312691448  
(9:30 AM - 6:00 PM) Monday – Saturday

techsupport@amkette.in

For Hassle Free Service Register Your Product  
www.amkette.com/register

6

## XS SERIES

Smart • Simple • Superior



# FLOW

Dual Scroll Rechargeable Bluetooth Mouse

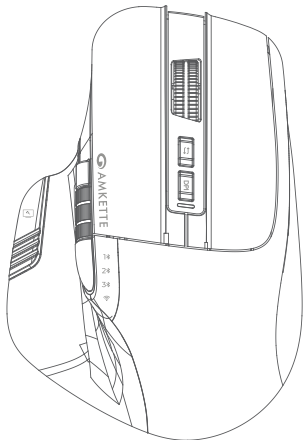

#### QUICK START GUIDE

#### IN THE BOX

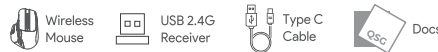

#### KNOW YOUR MOUSE

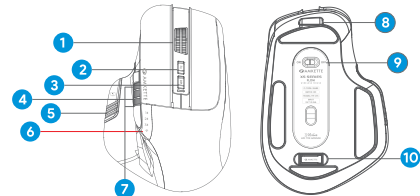

- 1 Vertical Scroll Wheel
- 2 Easy Device Switching
- 3 DPI Button
- 4 Horizontal Scroll Wheel
- 5 Show Desktop Button
- 6 Mode Indicator
- 7 Forward/Backward Button
- 8 Type C Input
- 9 ON/OFF Switch
- 10 USB Receptacle

DPI : Mouse supports Upto 3200 High-Precision DPI.

#### DPI Button – Adjustable Mouse Speed

Fine-tune your cursor movement with the DPI button:

- Cycles through 5 DPI levels: 400 / 800 / **1600** / 2400 / 3200
- Lower DPI = More precision (ideal for editing/design)
- Higher DPI = Faster movement (great for browsing or large screens)

2

#### CONNECTION GUIDE

**NOTE:** Before proceeding with the connection process, please ensure that the mouse is charged using the provided Type-C cable.

#### Connecting via Bluetooth

BT

You can connect up to 3 Bluetooth Devices simultaneously and seamlessly switch between them using the Device Switch Button.



To Pair a second device, Switch to BT Device 2, BT Device 3 and repeat the Pairing and Connection process.

Follow the same steps in case you want to forget and pair your mouse to a new device.

#### Connecting via USB 2.4GHz

USB

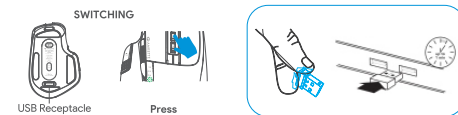

To connect a new receiver, switch to wireless mode and hold the device switch button until the light blinks.

3

#### Smart Controls & Shortcuts

Seamlessly switch between up to **4 devices (3 Bluetooth + 1 USB receiver)** using the **Device Switch button**.

- **Single Press:** Switches between connected devices
- **Blue Light (1/2/3):** Bluetooth 1, 2, or 3
- **Green Light:** USB Wireless Mode



#### Show Desktop Button (Windows & macOS)

This button is pre-configured for Windows, but can be switched to macOS mode when needed.

To Switch to macOS Mode:

- Press and hold the Show Desktop button for 3 seconds
- Now, a single press will show the desktop on macOS

Note: Mouse remembers the last OS setting for the Show Desktop.

#### COMPATIBLE OS



4

Front

Back